



Founders' Cottage

The Founders' Cottage is Ness Lake Bible Camp's premier rental facility, and provides a level of luxury unparalleled at Camp. This 5,000 square foot facility is designed for small group meetings and retreats. The Great Room (approximately 900 square feet) features leather couches, a river rock gas fireplace, a gorgeous 20' high vaulted ceiling, and a wall of windows overlooking Ness Lake. A full kitchen is located off the Great Room.

The spacious bedrooms offer privacy and comfort. Two bedrooms have ensuite bathrooms, and the remaining bedrooms share washroom facilities adjacent to the rooms. Other features include a second meeting area complete with gas fireplace and a patio facing the lake. The Founders' Cottage can accommodate 8 couples or small groups up to 19 people (26 persons family style) overnight.

Food Service:

Small groups using the Founders' Cottage will be expected to provide their own food service using the facilities provided in the building. Typically, food service will only be provided if those using the Founders' Cottage are part of a group that is renting the entire facility (25 or more people). In that case, food service will be provided through the camp kitchen, and meals will be served in the Dining Hall. Special arrangements may be made to provide catering for smaller groups in the Founders' Cottage.

Second Floor (level entry)

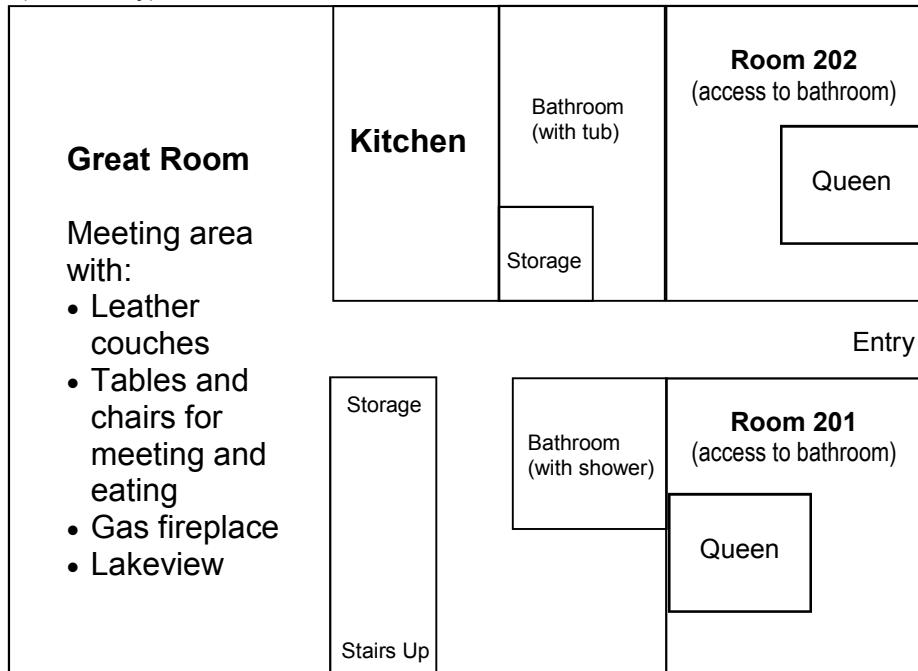

First Floor (level entry)

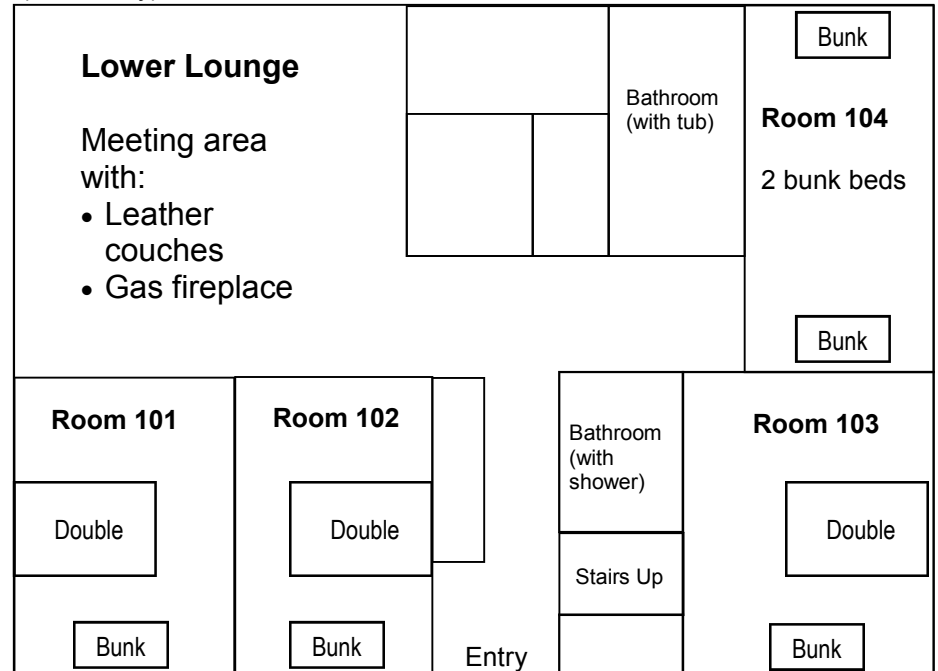

Third Floor (access from Second Floor)

